

50-B-56 - SPEEDLINE System Data Sheet - Version V1 (24-10-23)

SPEEDLINE 50mm 'C' Stud Partition @600mm Ctrs,
with BG Gyproc 15mm FireLine each side

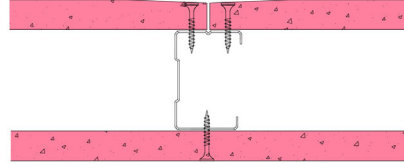

System Performance Breakdown

Fire Resistance:

BS476 Part 22:1987:

Test Ref & Date or Applied Ref & Report:

Max Height:

Thickness:

Duty Grade: BS 5234: Part 2:1992:

Sound Insulation:

60/60 Minutes (Integrity/Insulation).

BTC 17441F - 29/07/2011 & BRE Report P102396-1011A

Refer to Speedline Specification Clause

82 mm. (At Base Track, Excluding Finishes)

Heavy - Annexes A-F

37 R_wdB, Date Tested or Assessed Against - 70-B-51

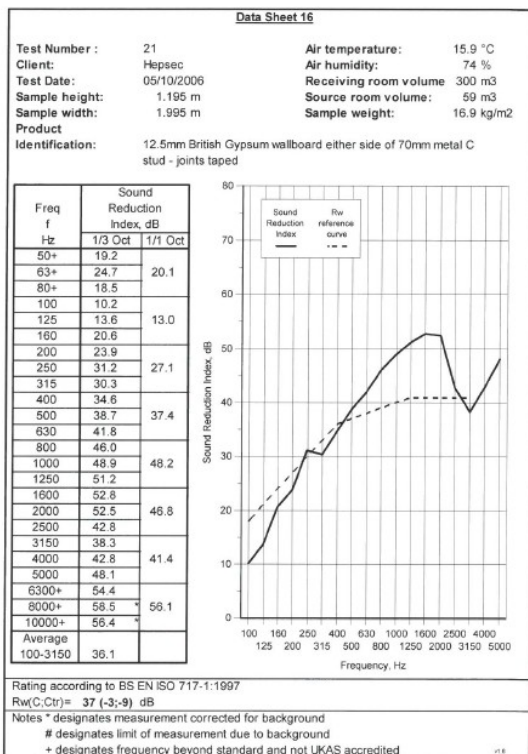

TESTED AT ONE OF THE UKAS ACCREDITED LABORATORIES BELOW

B.T.C (H-Ref on Graph)	
B.R.E	
AIRO	
S.R.L	